

FT22

- Einzeldichtung nach DIN 24960
- entlastet
- drehrichtungsunabhängig
- Wellenbefestigung mit Inbusschraube

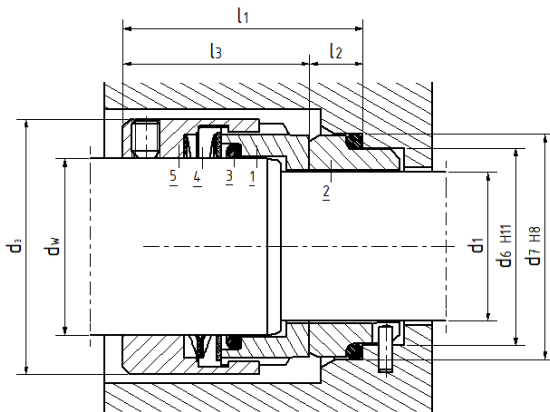

Einsatzgrenzen: d1 14-100 mm
 p 25 bar
 g 20 m/s
 t -50 bis + 200 °C

Komponenten: 1 Gleitring
 2 Gegenring
 3 Nebendichtungen
 4 Befederung
 5 Sonstige Teile

lt. Abbildung Pos. 2 FTG 9

Andere Gegenringvarianten auch möglich!

Werkstoffe

lt. Werkstofftabelle

Standard-Abmessungen (Fertigung nach Sondermaß auch möglich)

| d1 | d2 | d3 | d6 | d7 | l3 | l2 | l1 |
|-----|-----|-----|--------|--------|------|-------|------|
| 14 | 18 | 33 | 21.00 | 25.00 | 32.5 | 10.00 | 42.5 |
| 16 | 20 | 35 | 23.00 | 27.00 | 32.5 | 10.00 | 42.5 |
| 18 | 22 | 37 | 27.00 | 33.00 | 33.5 | 11.50 | 45 |
| 20 | 24 | 39 | 29.00 | 35.00 | 33.5 | 11.50 | 45 |
| 22 | 26 | 41 | 31.00 | 37.00 | 33.5 | 11.50 | 45 |
| 24 | 28 | 43 | 33.00 | 39.00 | 36 | 11.50 | 47.5 |
| 25 | 30 | 45 | 34.00 | 40.00 | 36 | 11.50 | 47.5 |
| 28 | 33 | 48 | 37.00 | 43.00 | 38.5 | 11.50 | 50 |
| 30 | 35 | 50 | 39.00 | 45.00 | 38.5 | 11.50 | 50 |
| 32 | 38 | 55 | 42.00 | 48.00 | 38.5 | 11.50 | 50 |
| 33 | 38 | 55 | 42.00 | 48.00 | 38.5 | 11.50 | 50 |
| 35 | 40 | 57 | 44.00 | 50.00 | 38.5 | 11.50 | 50 |
| 38 | 43 | 60 | 49.00 | 56.00 | 38.5 | 14.00 | 52.5 |
| 40 | 45 | 62 | 51.00 | 58.00 | 38.5 | 14.00 | 52.5 |
| 43 | 48 | 65 | 54.00 | 61.00 | 38.5 | 14.00 | 52.5 |
| 45 | 50 | 67 | 56.00 | 63.00 | 38.5 | 14.00 | 52.5 |
| 48 | 53 | 70 | 59.00 | 66.00 | 38.5 | 15.00 | 52.5 |
| 50 | 55 | 72 | 62.00 | 70.00 | 42.5 | 15.00 | 57.5 |
| 53 | 58 | 79 | 65.00 | 73.00 | 42.5 | 15.00 | 57.5 |
| 55 | 60 | 81 | 67.00 | 75.00 | 42.5 | 15.00 | 57.5 |
| 58 | 63 | 84 | 70.00 | 78.00 | 47.5 | 15.00 | 62.5 |
| 60 | 65 | 86 | 72.00 | 80.00 | 47.5 | 15.00 | 62.5 |
| 63 | 68 | 89 | 75.00 | 83.00 | 47.5 | 15.00 | 62.5 |
| 65 | 70 | 91 | 77.00 | 85.00 | 47.5 | 15.00 | 62.5 |
| 70 | 75 | 99 | 83.00 | 92.00 | 52 | 18.00 | 70 |
| 75 | 80 | 104 | 88.00 | 97.00 | 52 | 18.00 | 70 |
| 80 | 85 | 109 | 95.00 | 105.00 | 51.8 | 18.20 | 70 |
| 85 | 90 | 114 | 100.00 | 110.00 | 56.8 | 18.20 | 75 |
| 90 | 95 | 119 | 105.00 | 115.00 | 56.8 | 18.20 | 75 |
| 95 | 100 | 124 | 110.00 | 120.00 | 57.8 | 17.20 | 75 |
| 100 | 105 | 129 | 115.00 | 125.00 | 57.8 | 17.20 | 75 |